

Pre-Assembly Procedures

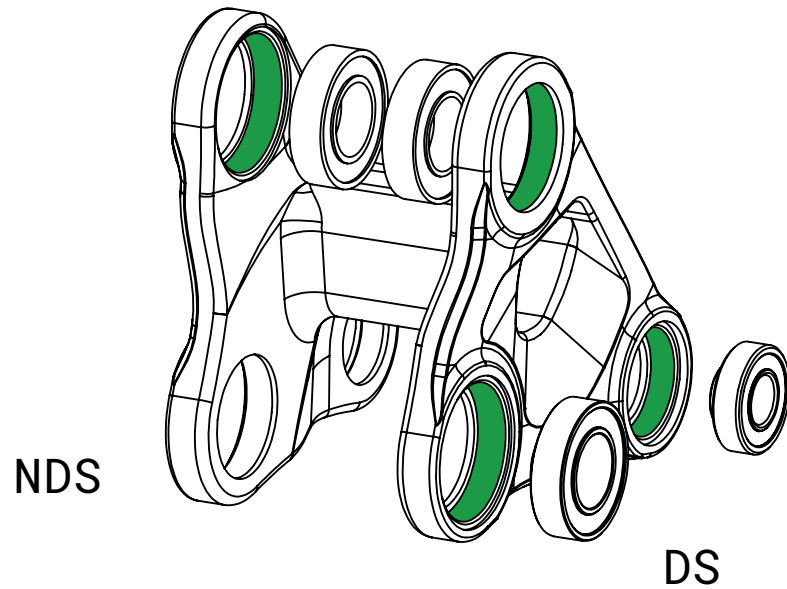

Frame Assembly Procedures

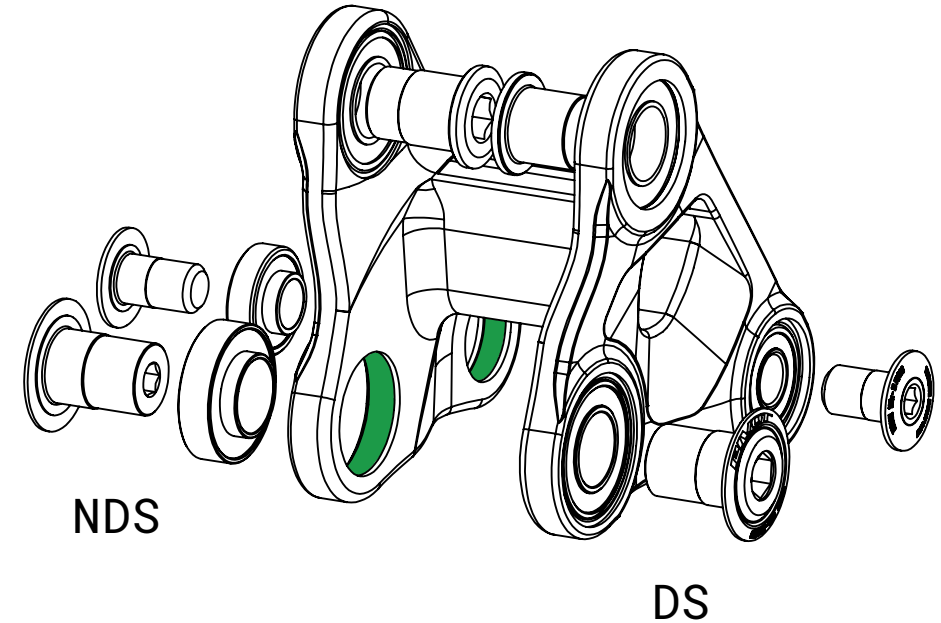

PART NUMBERS:

LINK:	FP-LNK-UL-66MM-V1-R1
BEARINGS:	FP-BRG-6902-LLUMAXECN-B0 FP-BRG-6902-LLUMAX-B0 FP-BRG-6900-LLUMAXE-B0
BOLTS:	FP-BLT-M14*20-BLK-V2-R2 FP-BLT-M14*20-BLK-V3-R2 FP-BLT-M10*16.5-BLK-V1
SPACERS:	FP-WSH-SPC-15I*250*3W
FLIP CHIPS:	FP-NUT-FLIPCHIP-4.6MM-V1

Notes:

- Use **loctite #638** or equivalent on all bearing pockets before assembling to frame
Spread evenly around the bearing pocket with a round wooden toothpick
- Use **loctite #243** or equivalent on **frame threads** for each bolt during frame assembly
Spread evenly around the female frame threads with a round wooden toothpick
- All bearings installed during pre-assembly are press fit
- All bearings installed during frame assembly are slip fit
- After assembly clean any excess loctite from the bearings, links, and frame
- After completing the link pre-assembly procedure, align the link with the Frame and install drive side bolts and torque to spec.
- For Frame assembly, install non-drive side bearings and bolts then torque to spec.

Do not apply Loctite to bolt threads.



The information contained in this drawing is the sole property of Pivot cycles and is not to be released without prior written approval.